

Proposed Refuse storage

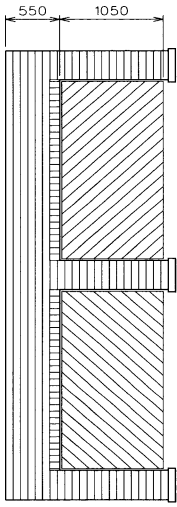
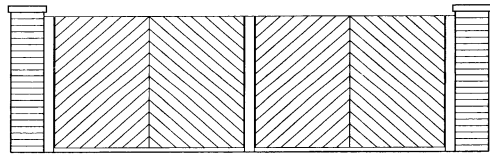
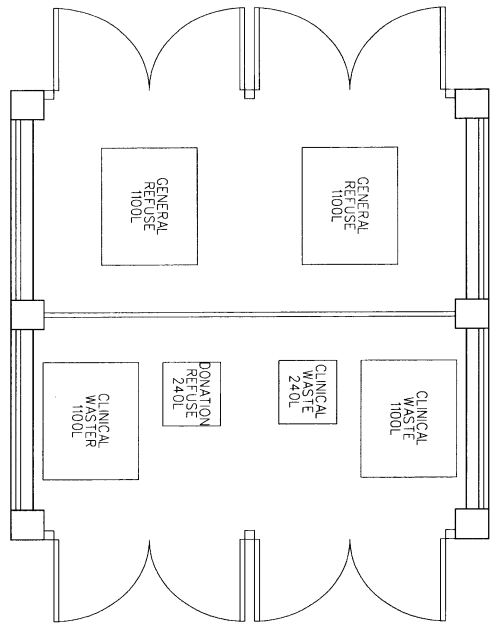

BLOCK A & B - REFUSE STORE

Brick plinth incorporating brick piers and treated timber infill panels with operational waste serving Blocks A & B.

STOCKTON BOROUGH COUNCIL
PLANNING
04 MAR 2018
DATE RECORDED

13/0534/

REVISION DATE / DESCRIPTION
REVISION A - 04/03/18
REVISED TO NEW BRICK SCHEME

A	DATE

STAGE - PLANNING

PROJECT
BRICK PLINTH AND TREATED TIMBER INFILL
REFUSE STORES

CLIENT
MARIO NICOLAIA ARCHITECTS LTD

DATE
DEC 09

PROJECT NO
A14

DATE
DEC 09

PROJECT NO
A14

DATE
DEC 09

PROJECT NO
A14

DATE
DEC 09

PROJECT NO
A14

DATE
DEC 09



Proposed Boundary Treatments

BOUNDARY NOTES

South boundary line to be open with 600mm high shrub buffer forming visual boundary East and North boundary as existing.

BLOCK B - FRONT GARDEN

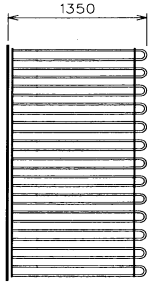

1.35m high painted steelhoop top profiled railings to enclose front area of Block B private garden area

BLOCK A - REAR GARDEN FENCE TYPE

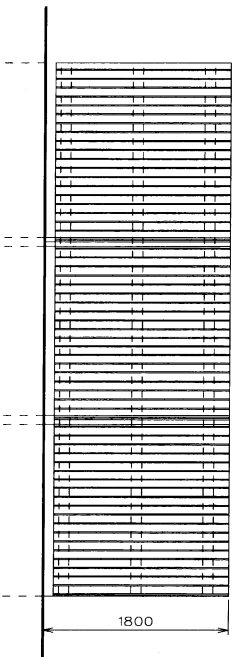

1.8m high vertical close boarded timber fencing
100 x 25 boards at 112mm crs,
100 x 100mm posts at 2 metre crs with
3no. 100 x 50mm rails all stained using Cuprinol Teak

WEST BOUNDARY TREATMENT

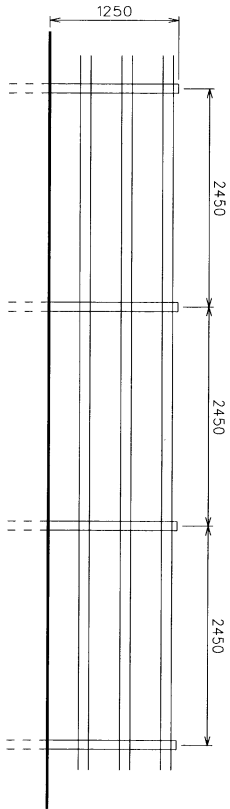

1.25m ranch-style timber fencing,
3no. 100x25 plank rails on 75x75 posts at 2.45m centres



13/0534/

REVISION DATE / DESCRIPTION

NO.	DATE	DESCRIPTION
1	04 MAR 2013	DATE RECORDED

D	DATE

SINGLE PLANNING
DATE RECORDED
04 MAR 2013

PROPOSED BOUNDARY DETAILS

NO.	DATE	NO.	NO.
1	04 MAR 2013	0	0

DATE	NO.	NO.	NO.
DEC 09	100003	100	100

WORLD ARCHITECTS LTD

Proposed Site Plan

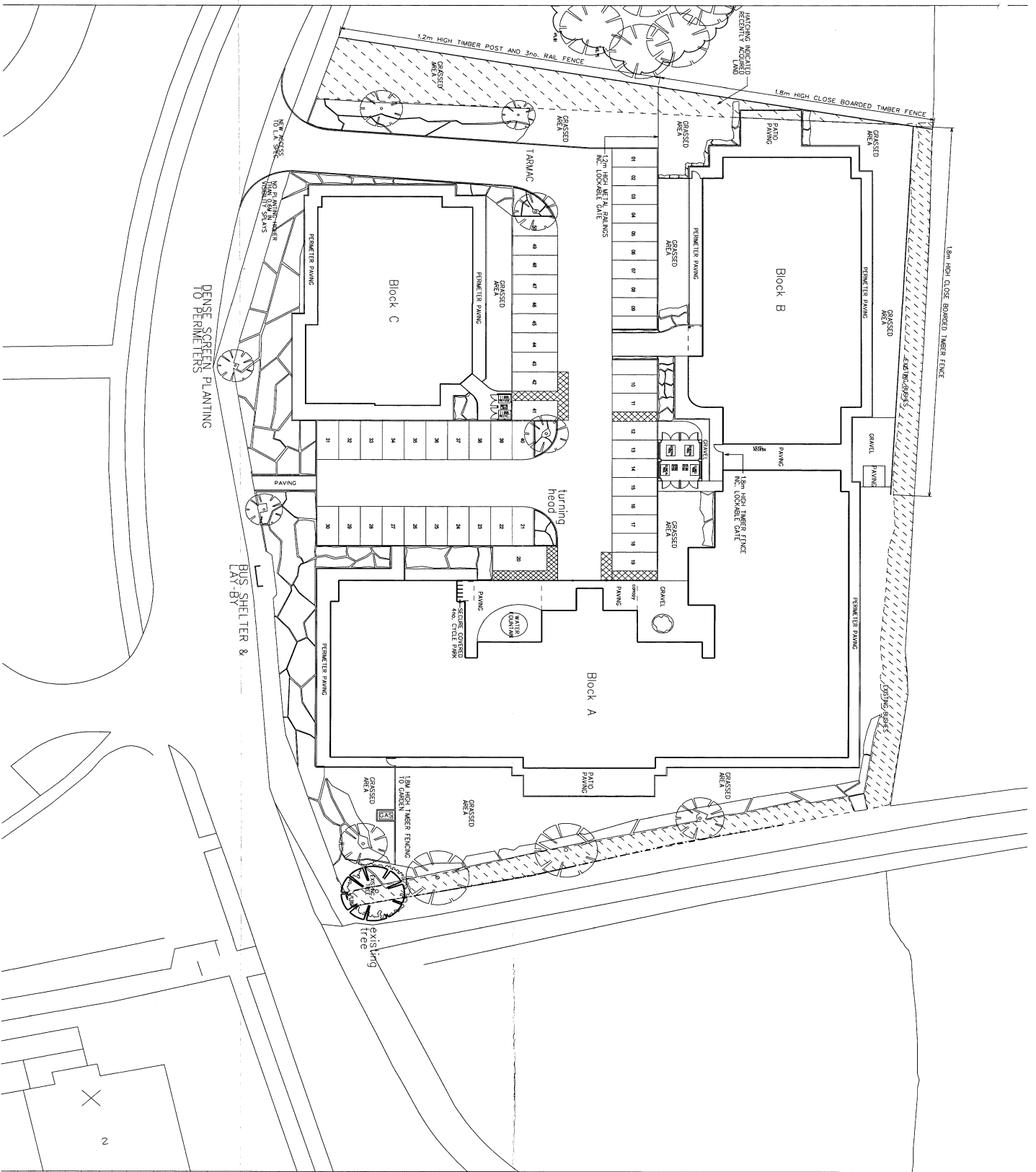

<p>REVISION DATE / DESCRIPTION</p> <p>K. 20/11/2011 REVISION: REVISION OF SECTION INDICATIONS AND REVISIONS</p> <p>L. 20/11/2011 REVISION: REVISION OF SECTION INDICATIONS AND REVISIONS</p> <p>M. 20/11/2011 REVISION: REVISION OF SECTION INDICATIONS AND REVISIONS</p> <p>N. 20/11/2011 REVISION: REVISION OF SECTION INDICATIONS AND REVISIONS</p>	
<p>PROJECT NO. 13/0534 /</p>	
<p>PROJECT NAME: PROPOSED SITE PLAN</p>	
<p>CLIENT: CASE HODGE & COMPANY/ANIMATED PRODUCTIONS</p>	
<p>DATE: MAY 10 1:2008AM</p>	
<p>SCALE: A-02</p>	
<p>DRAWN BY: K</p>	
<p>CHECKED BY: M</p>	
<p>APPROVED BY: M</p>	
<p>DATE: MAY 10 1:2008AM</p>	
<p>PROJECT NO. 13/0534 /</p>	
<p>PROJECT NAME: PROPOSED SITE PLAN</p>	
<p>CLIENT: CASE HODGE & COMPANY/ANIMATED PRODUCTIONS</p>	
<p>DATE: MAY 10 1:2008AM</p>	
<p>SCALE: A-02</p>	
<p>DRAWN BY: K</p>	
<p>CHECKED BY: M</p>	
<p>APPROVED BY: M</p>	
<p>DATE: MAY 10 1:2008AM</p>	

Proposed Landscaping Plan

PROPOSED LANDSCAPING PLAN

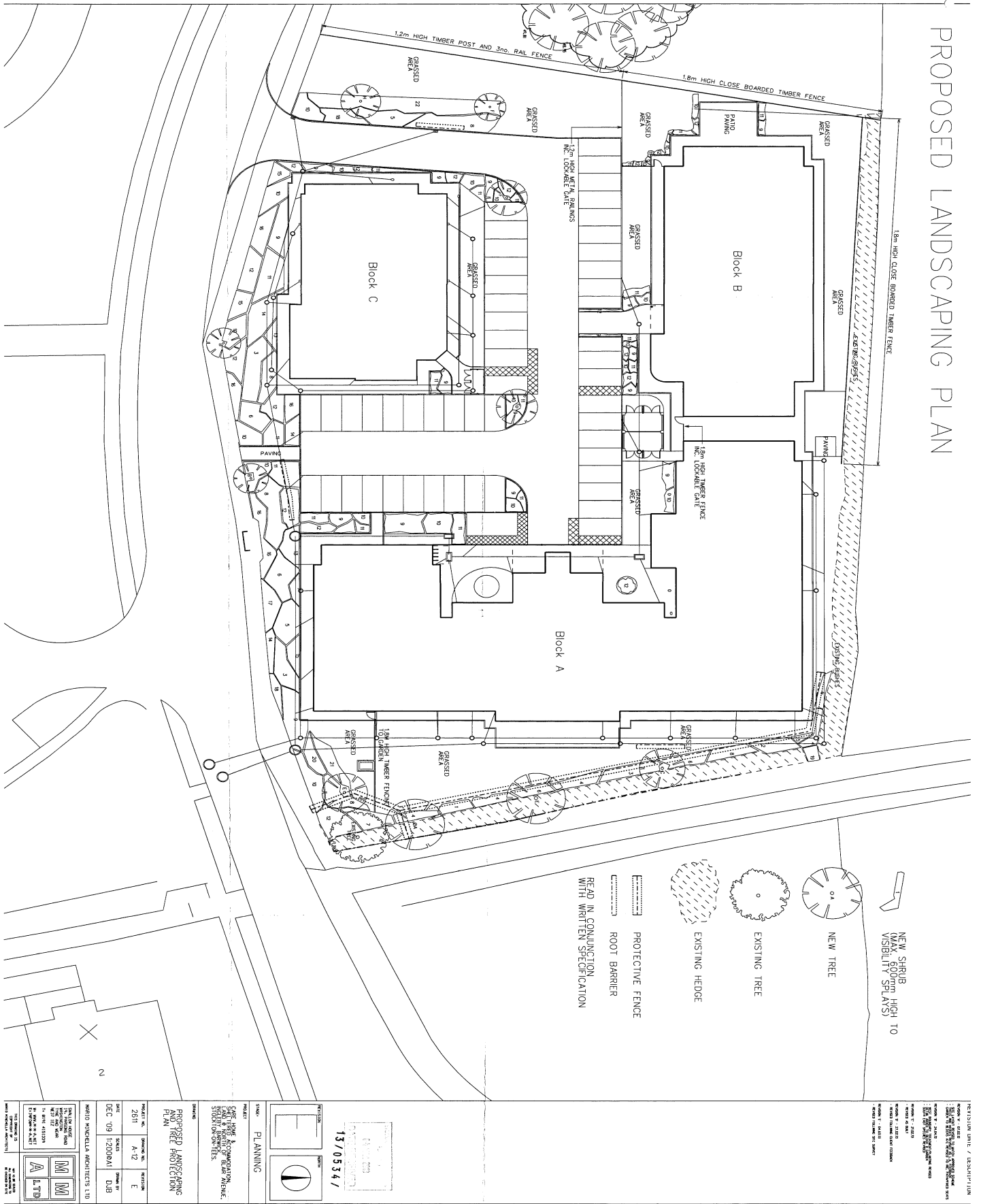

NEW SHRUB HIGH TO VIEW GOVERN VISIBILITY SPLAYS

NEW TREE

EXISTING TREE

EXISTING HEDGE

PROTECTIVE FENCE

ROOT BARRIER

READ IN CONJUNCTION WITH WRITTEN SPECIFICATION

1:3/0534

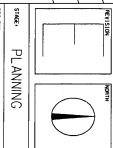

PROJECT: PLANNING

CLIENT: THE CORPORATION OF THE BOROUGH OF STOCKPORT

PROPOSED LANDSCAPING PLAN
SITE PROTECTION

PROJECT NO.	2611	REVISION	E
DATE	A-12	ISSUED BY	
DATE	DEC 09	ISSUED BY	DJB

MARIO MICHIELLA ARCHITECTS LTD

